

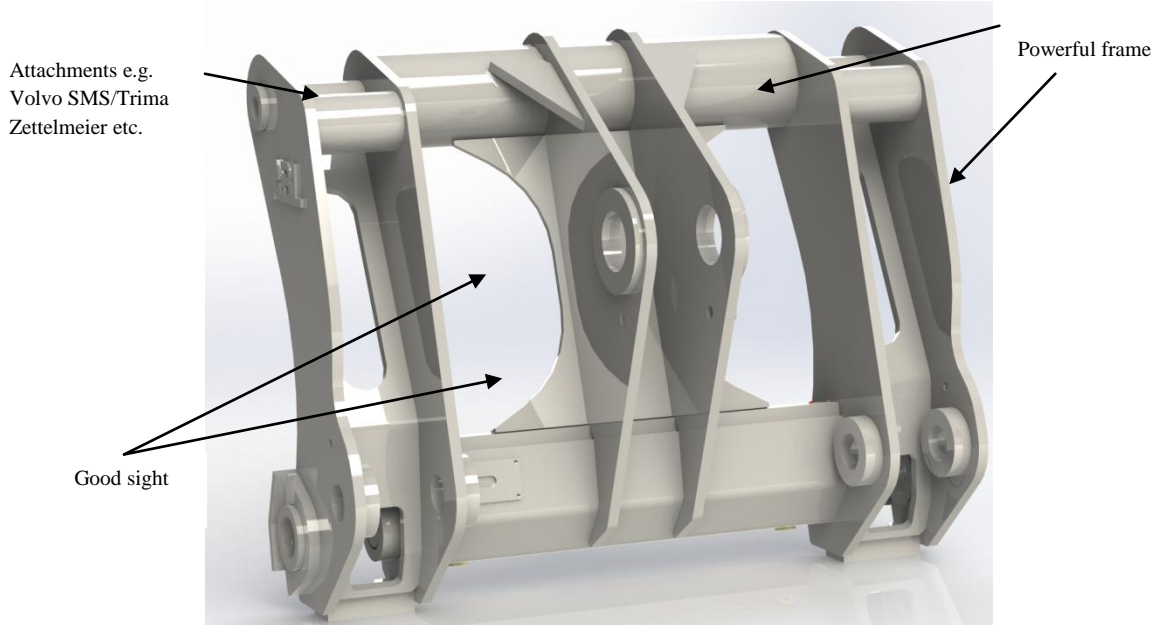

# HYDRAULIC QUICK COUPLER

## HYDRAULIC QUICK COUPLER

Our quick couplers are characterized by high quality from the beginning of construction to production. It means good sight, customized for machine's kinematics, short dimension and a good quality. Quick couplers of ABL are very popular and have got a high demand on the market. They are being manufactured to the most kinds of machines.



**ABL CE**, can in this range as standard offer attachments for compact wheel-loaders to the bigger ones at 60 tonnes and also for the most of the telescope handlers. We offer attachments like Volvo, SMS/Trima, Zettelmeier, etc.

## Options

- Electric valve (12V or 24V) and thematic connections, electrical cable and a contact (3:rd hydraulic function machine)
- Three-way valve
- Shafts and machine hoses

## Advantages

- + Good construction
- + Customized for every model of machines
- + Short dimension
- + Good sight

**Please contact your nearest retailer or ABL Construction Equipment for more information or a quotation.**

ABL Construction Equipment | Svetsargatan1 | 576 33 Sävsjö | Tel +46 382 67600 | [info@abl.se](mailto:info@abl.se) | [www.abl.se](http://www.abl.se)



Bästa lösningen finns ofta  
rakt framför näsan.